

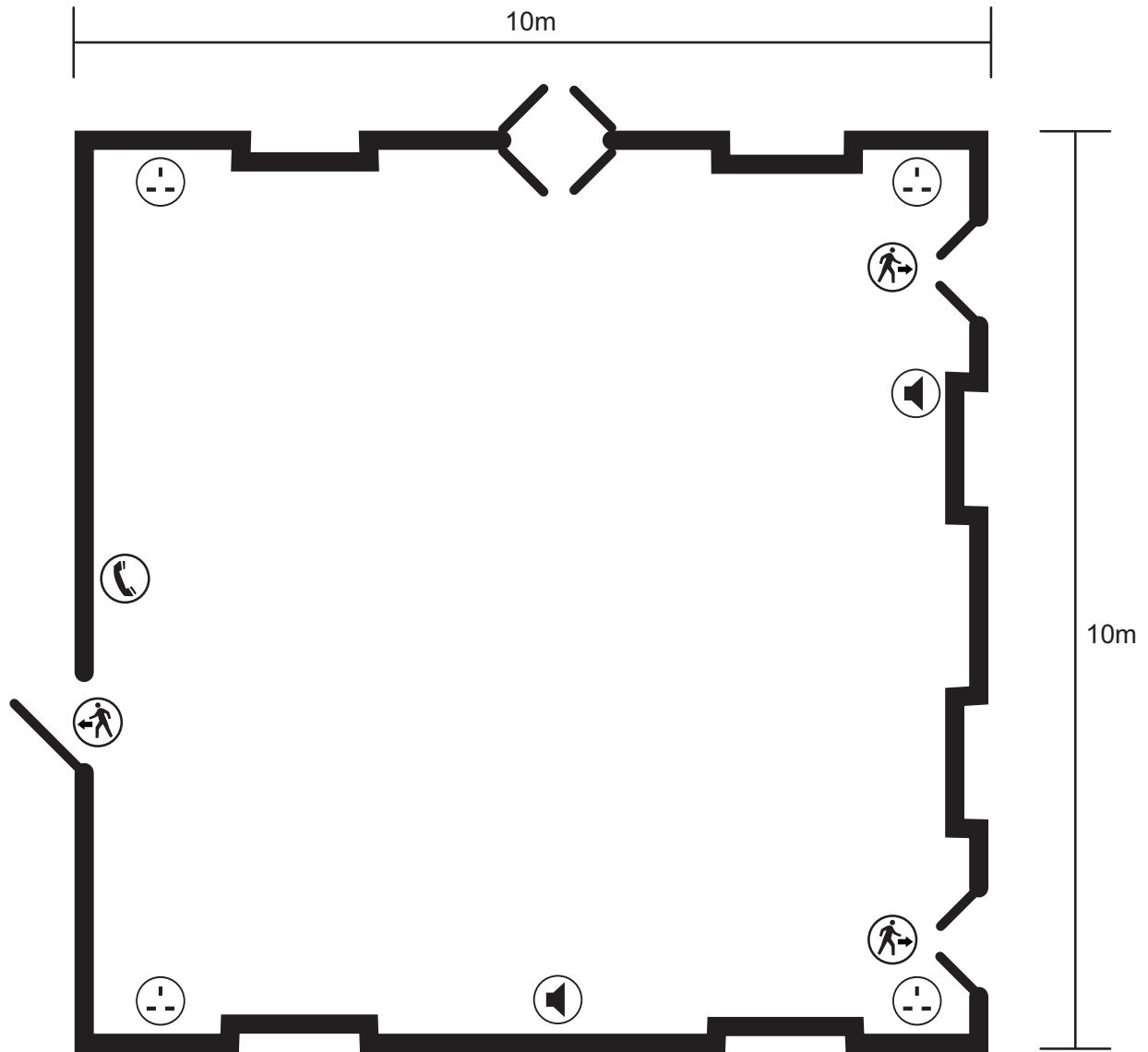







## Albert Room



### Key:

-  Telephone points
-  Power points (2 sockets)
-  Power points (multiple sockets)

-  Light switch
-  Broadband connection
-  Microphone socket
-  Fire exit

## Albert Room



### Room layout capacities

Theatre	120
Classroom	40
Boardroom	40
Dinner dance	n/a
Banquet	n/a
Cabaret	100
Reception	100
U-shape	30
Exhibition	100sq m

### Technical specification

Length	10m
Width	10m
Ceiling height	8.8m
Sq m	100m
Natural daylight	Partial
Blackout	No
Air cond	No
Phone	Yes
ISDN	No
Internet	Yes
Access level	Ground
Wheelchair access	Yes